

Natalie Milan Portfolio

Snapshot of completed works -
Residential & Commercial Interiors



PROJECTS

01 - Gallerie Studio

02 - Pavilions of Lenswood

03 - New Townhouse
Development, Hambledon rd

04 - New Townhouse
Development, Maynard Ave

05 - Kitchen Renovation,
Nurioopta, Barossa Valley

01



Gallerie Studio

A purpose built studio showcasing residential external and interior finishes. Managed by Qualified Interior Designers, who take the client throughout the whole house selection and design process on behalf of the builder. The Gallerie Studio proved successful in the Melbourne market, so the directors decided to spread the success and venture into the Adelaide market.

Gallerie Studio cont.....

Appointed as the Gallerie Manager my Initial role with the company was to project manage the conversion of the 1000m² warehouse space from shell to completion.

The space was carefully planned out to take the clients on a journey from the externals to the internal selections of their new or renovated home.

Starting from the bricks, cladding, right through to flooring, sanitary ware, kitchens and finally paints, cornicing and blinds.

The project was completed in 6 months.

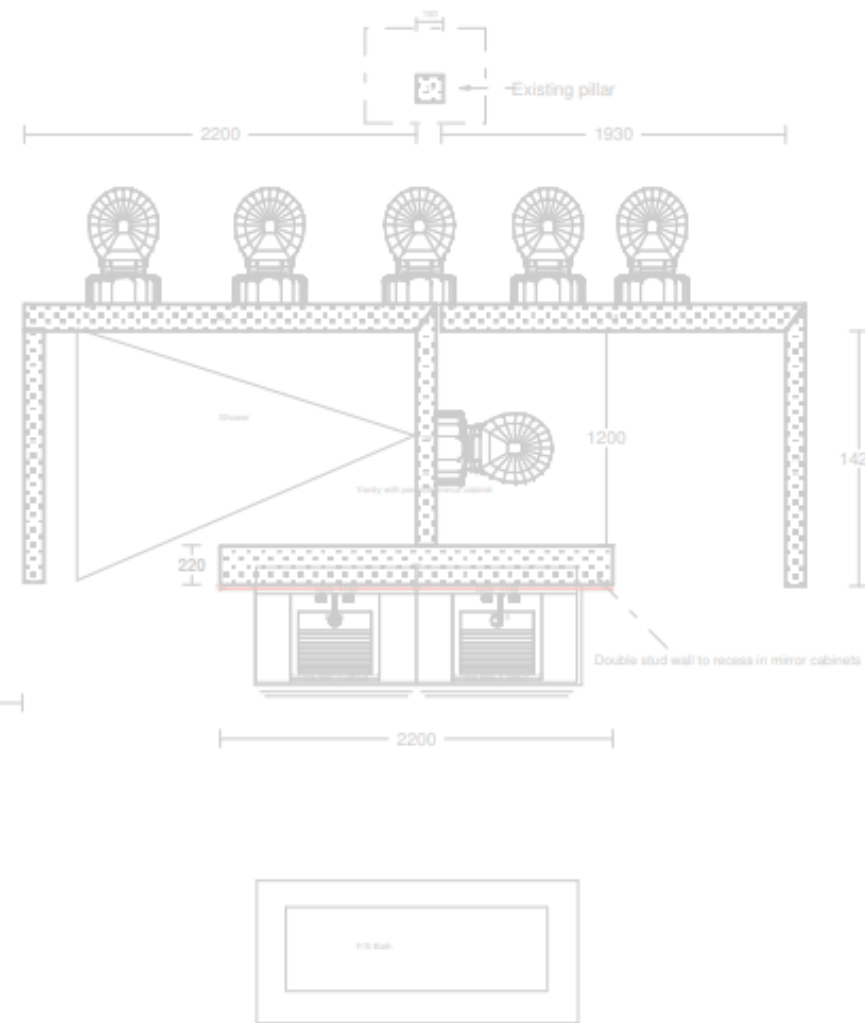
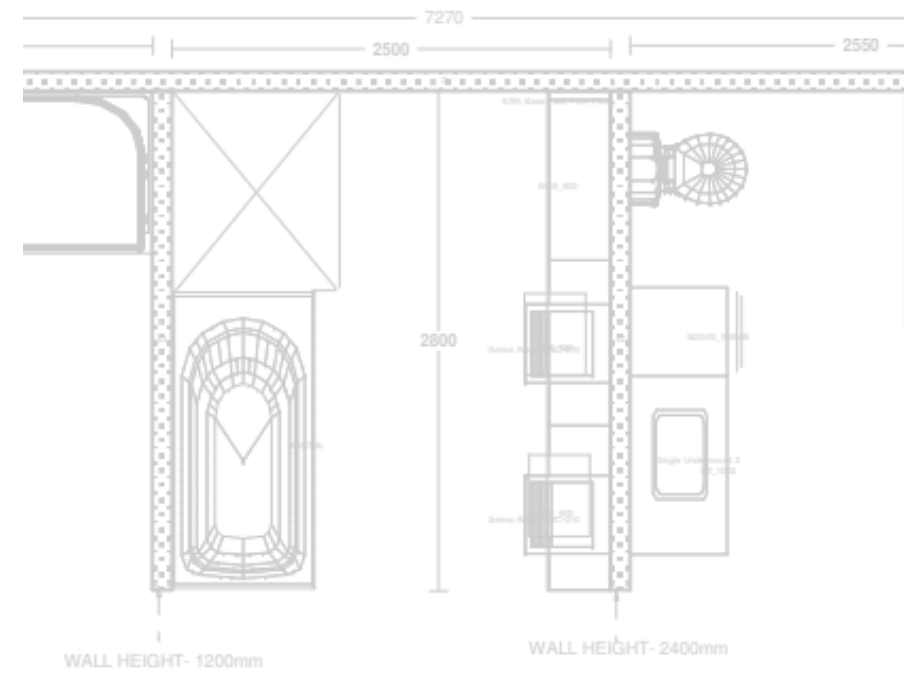

Pavilions at Lenswood

Brief - to create high end accomodation pods for guests to enjoy complete relaxation and take in the beautiful surroundings of the famous apple orchids and vinyards of the Adelaide Hills



Hambleton Rd, Townhouse Development



Three townhouse development with Belroc Homes. Purpose built for sale with a higher spec.
A single colour scheme was used for all 3 houses.



Maynard Ave, Townhouse Development

Project - 7 Townhouse Development, with
Belroc Homes

2 Internal Schemes were created for this
project. A light and a dark scheme to suit
different buyers

Recycled looked bricks were also chosen to
create a contrast between the render and
the dark monument colorbond roof and
aluminium windows

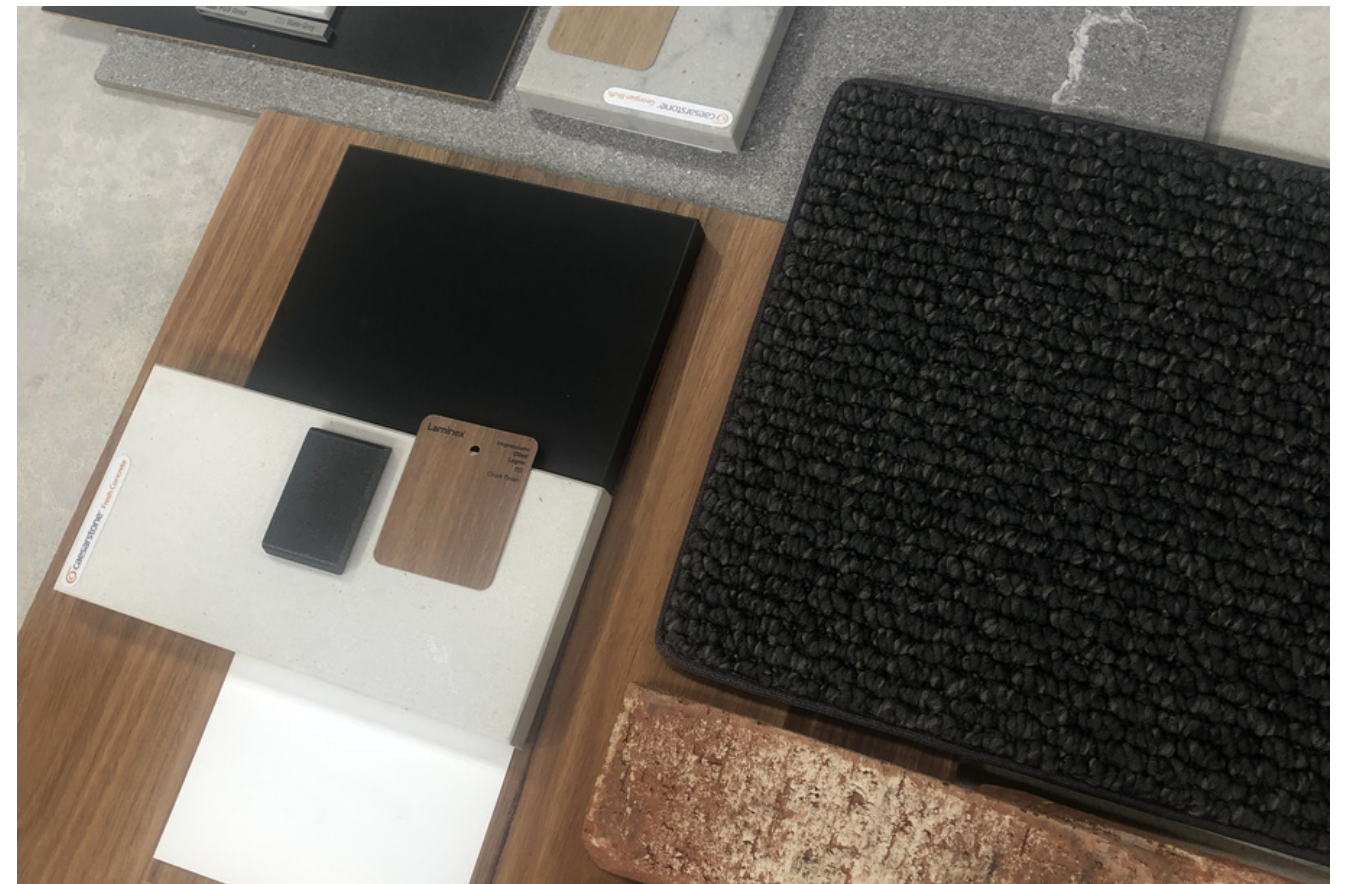



Kitchen Renovation

Nurioopta, South Australia

Brief - To create a functional space in a 1901 Victorian cottage in the middle of the famous Barossa Valley, for a young wine maker family who enjoy cooking.

The clients were very specific on their needs and had already purchased their Falcon Freestanding Cooker and requested a farmhouse butlers sink. These become the focal points of the kitchen.